

# Oil Alert™ 3-Zone Alarm Panel



Leading Edge Control Products

Rated Type 1, Indoor Alarm Panel

ALARM PANEL ONLY (USE WITH ALDERON™ OIL ALERT™ SERIES)

TECHNICAL DATA SHEET

## DESCRIPTION OF OPERATION



(8025 model shown)

The Oil Alert™ 3-Zone Alarm is an indoor rated alarm panel, powered by a standard 120VAC wall outlet. When powered, the green LED will illuminate on the alarm panel. This alarm is used with Alderon™ Oil Alert™ control panels for the safe operation of pumping, alarming, and monitoring of: elevator sump pits, transformer vaults, and leachate well applications. Alarm models include: standard, tank alarm, and holding tank. The Oil Alert™ control panel will activate a pump to remove water from pits in accordance with ASME A17.1, stopping the pump before oil or other harmful substances enter the water supply.

The alarm panel is equipped with audible and visual alarm indication for three zones. A preset level sensor is wired to the control panel from the monitoring area and the control panel auxiliary contacts are wired to the terminal block on the alarm panel. Installing a 9VDC battery (not included) provides battery backup during power outages. Use the alarm panel auxiliary contacts to connect to building automation systems (BAS) and phone dialers.

An alarm condition will occur when the sensor for zone-1, zone-2, and/or zone-3 activates. During an alarm condition, the red alarm LED will illuminate, buzzer will annunciate, and the auxiliary contacts will activate. Press the alarm silence pushbutton during an alarm condition to silence the buzzer, the alarm LED will remain on until the sensor deactivates. The silence condition will reset when the sensor deactivates and the alarm panel will auto reset for the next alarm cycle.

NOTE: If zone-1 is in an alarm condition and the buzzer is silenced, and then zone-2 and/or zone-3 goes into an alarm condition, the buzzer will reactivate until the alarm silence pushbutton is pressed to acknowledge that a new alarm condition has occurred.

## STANDARD FEATURES



(1) **Power On LED** - A green LED illuminates on the front of the alarm panel to indicate the power is on.

(2) **Alarm LEDs** - During an alarm condition in zone-1, the red alarm LED will illuminate on the front of the alarm panel. During an alarm condition in zone-2, the red alarm LED will illuminate on the front of the alarm panel. During an alarm condition in zone-3, the red alarm LED will illuminate on the front of the alarm panel.

(3) **Alarm Buzzer** - The alarm buzzer will annunciate in addition to the visual indication provided by the red LEDs during an alarm condition in any individual and/or combination of zones for zone-1, zone-2, and/or zone-3.

(4) **Alarm Test Pushbutton** - Press the pushbutton to test the alarm to ensure proper operation. The buzzer should annunciate, alarm LEDs should illuminate, and auxiliary contacts should activate.

(5) **Alarm Silence Pushbutton** - Press the pushbutton to silence the buzzer during an alarm condition. The alarm LEDs remain illuminated until the alarm condition has been cleared and the alarm panel will auto reset for the next alarm cycle.

(6) **Terminal Block** - Connect the control panel auxiliary contacts to the terminals on the alarm panel.

(7) **Auxiliary Contacts** - Interface with an external device including BAS systems and phone dialers. The contacts (normally open) are rated 24VDC/24VAC, 50/60 Hz, and 100mA maximum.

(8) **Battery Backup** - Install a 9VDC battery (not included) for battery backup during power outages.

(9) **Panel Compartment** - Wire connector for 9VDC battery (backup power), auxiliary dry contacts, and access cover with break away tabs for routing wire.

# SPECIFICATIONS

## Oil Alert™ 3-Zone Alarm, Panel Only

**Primary Power**  
120VAC, 60 Hz  
(5-foot power cord)

**Secondary Power**  
Class 2, 9-11.1VDC, 500mA

**Auxiliary Contacts**  
Normally Open  
Class 2, 24VDC/24VAC (50/60 Hz)  
100mA maximum  
Terminal RC = Common/All Zones  
Terminals RC and 1A = Zone-1 (specific per model)  
Terminals RC and 2A = Zone-2 (specific per model)  
Terminals RC and 3A = Zone-3 (specific per model)

**Control Panel Auxiliary Contacts**  
9VDC, 200mA minimum  
(control panel signaling contacts)

**Battery Backup**  
Standard 9VDC battery  
(not included)

**Buzzer**  
95 dB @ 2-feet

**Enclosure**  
Type 1, Indoor

**Certifications**  
CSA (US and Canada)

**Three-Year Limited Warranty**

## MECHANICAL DRAWING

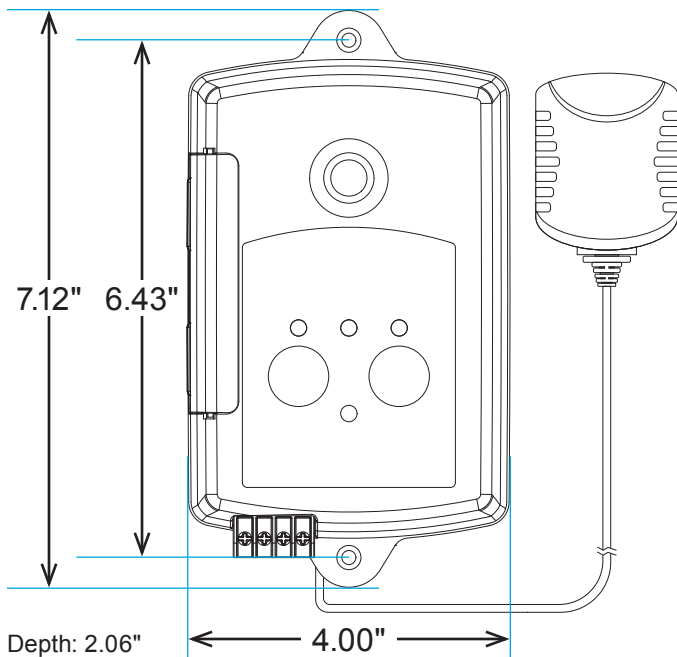

## WIRING EXAMPLES

### Auxiliary Contacts

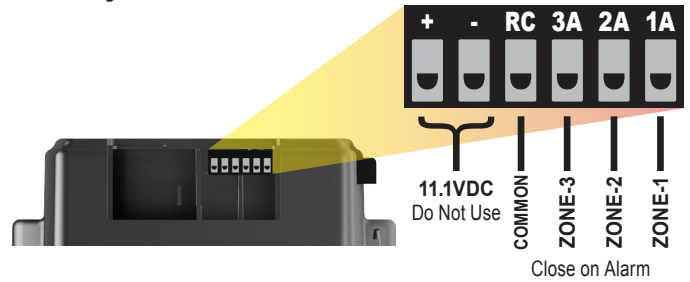

### Field Connections

NOTE: Use 18 gauge wire.

CAUTION: The auxiliary contacts are low voltage wires and cannot be run in a conduit with high voltage wires.

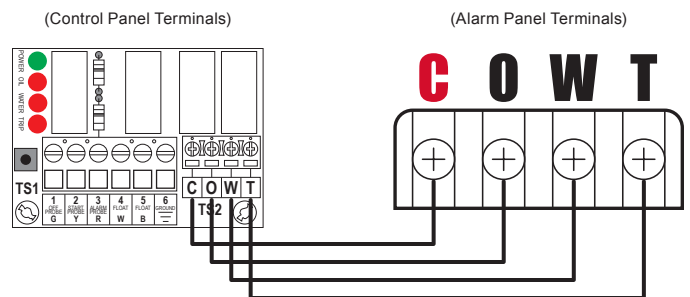

## ORDERING INFORMATION

For a complete list of standard products with pricing, refer to the current year price sheet or visit [alderonind.com](http://alderonind.com) for more information.

PART NUMBER	DESCRIPTION (Alarm Panel includes: Auto Reset, Battery Backup, and Auxiliary Contacts)
8025	Oil Alert™ 3-Zone - Standard Alarm, High Oil/High Water/Pump Overload (Alarm Panel Only)
8026	Oil Alert™ 3-Zone - Holding Tank Alarm, Tank Filling/Alarm Tank Full/High Sump Level (Alarm Panel Only)
8027	Oil Alert™ 3-Zone - Valve Separator Alarm, High Oil/High Water/High Holding Tank (Alarm Panel Only)
OIL ALERT™ CONTROL PANELS and SENSORS	
7411-11	Oil Alert™ Single Phase Simplex, Overload, 120VAC, 4.0-6.0 Amps, Type 1, 25' Probe Sensor, 3-Zone Oil Alert™ Alarm Panel
7868	Oil Alert™ Three Phase Duplex, Hardwire, 208/230/460VAC, 4.0-6.3 FLA, Type 1, 25' Probe Sensor, 3-Zone Oil Alert™ Alarm Panel
7793	Oil Alert™ Standard Probe Holder/Float Sensor Assembly, 25' Cable (Sensor Only)
7912	Oil Alert™ Standard Probe Holder/Float Sensor Assembly, 50' Cable (Sensor Only)