

**Dimensions**

Project: \_\_\_\_\_ Model: \_\_\_\_\_ Chk'd: \_\_\_\_\_ Date: \_\_\_\_\_

**Model DWU**  
Manual Operation Pumps

Unit: inch (mm)

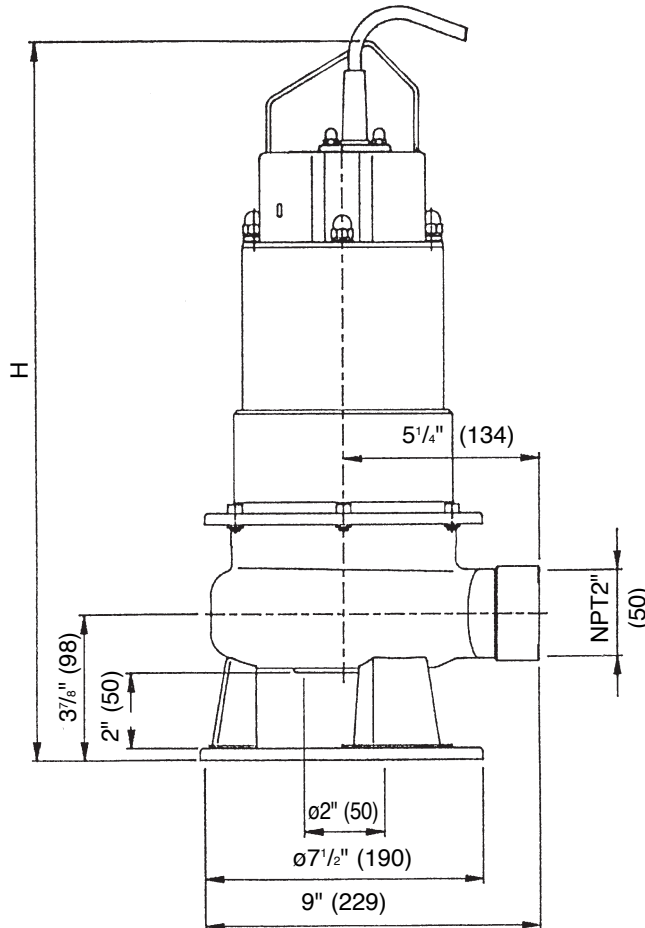

*Note: Three phase motors are equipped with a Power Cable and a Thermal Protection Cable*

Phase	Size ø	Model	Output		Pump	Weight Lbs (kg)
			kw	HP	H	
Single	2" (50mm)	50DWU6.4S	0.4	1/2	21 <sup>5</sup> / <sub>8</sub> (550)	35 (16)
		50DWU6.75S	0.75	1	22 <sup>13</sup> / <sub>16</sub> (580)	40 (18)
		50DWU6.4S2	0.4	1/2	19 <sup>1</sup> / <sub>8</sub> (485)	35 (16)
		50DWU6.75S2	0.75	1	20 <sup>1</sup> / <sub>4</sub> (515)	40 (18)
		50DWU61.1S2	1.1	1 1/2	20 <sup>1</sup> / <sub>4</sub> (515)	44 (20)
		50DWU61.5S2	1.5	2	24 (610)	51 (23)
Three	2" (50mm)	50DWU6.4	0.4	1/2	19 <sup>1</sup> / <sub>8</sub> (485)	33 (15)
		50DWU6.75	0.75	1	19 <sup>1</sup> / <sub>8</sub> (485)	35 (16)
		50DWU61.1	1.1	1 1/2	20 <sup>1</sup> / <sub>4</sub> (515)	40 (18)
		50DWU61.5	1.5	2	20 <sup>1</sup> / <sub>4</sub> (515)	44 (20)
		50DWU62.2	2.2	3	21 <sup>7</sup> / <sub>16</sub> (545)	55 (25)

**Dimensions**

Project: \_\_\_\_\_ Model: \_\_\_\_\_ Chk'd: \_\_\_\_\_ Date: \_\_\_\_\_

**Model DWXU**  
Manual Operation Pumps

Unit: inch (mm)

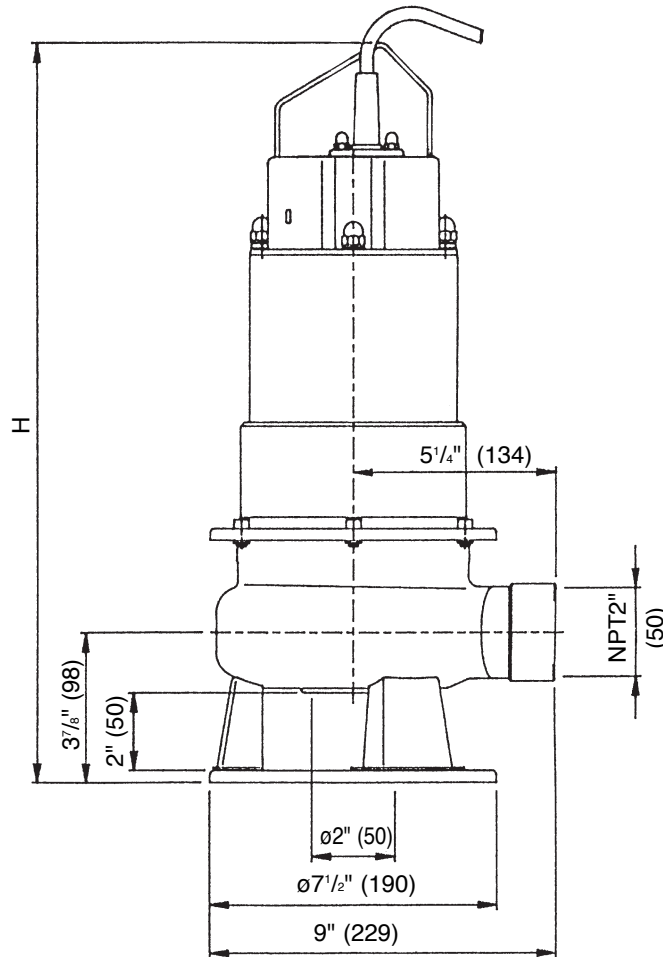

*Note: Three phase motors are equipped with a Power Cable and a Thermal Protection Cable*

Phase	Size ø	Model	Output		Pump	Weight Lbs (kg)
			kw	HP	H	
Single	2" (50mm)	50DWXU6.4S	0.4	1/2	21 <sup>5</sup> / <sub>8</sub> (550)	35 (16)
		50DWXU6.75S	0.75	1	22 <sup>13</sup> / <sub>16</sub> (580)	40 (18)
		50DWXU6.4S2	0.4	1/2	19 <sup>1</sup> / <sub>8</sub> (485)	35 (16)
		50DWXU6.75S2	0.75	1	20 <sup>1</sup> / <sub>4</sub> (515)	40 (18)
		50DWXU61.1S2	1.1	1 1/2	20 <sup>1</sup> / <sub>4</sub> (515)	44 (20)
		50DWXU61.5S2	1.5	2	24 (610)	51 (23)
Three	2" (50mm)	50DWXU6.4	0.4	1/2	19 <sup>1</sup> / <sub>8</sub> (485)	33 (15)
		50DWXU6.75	0.75	1	19 <sup>1</sup> / <sub>8</sub> (485)	35 (16)
		50DWXU61.1	1.1	1 1/2	20 <sup>1</sup> / <sub>4</sub> (515)	40 (18)
		50DWXU61.5	1.5	2	20 <sup>1</sup> / <sub>4</sub> (515)	44 (20)
		50DWXU62.2	2.2	3	21 <sup>7</sup> / <sub>16</sub> (545)	55 (25)

**Dimensions**

Project: \_\_\_\_\_ Model: \_\_\_\_\_ Chk'd: \_\_\_\_\_ Date: \_\_\_\_\_

**Model DWAU**  
**Model DWXAU**  
 Automatic Operation Pumps

Unit: inch (mm)

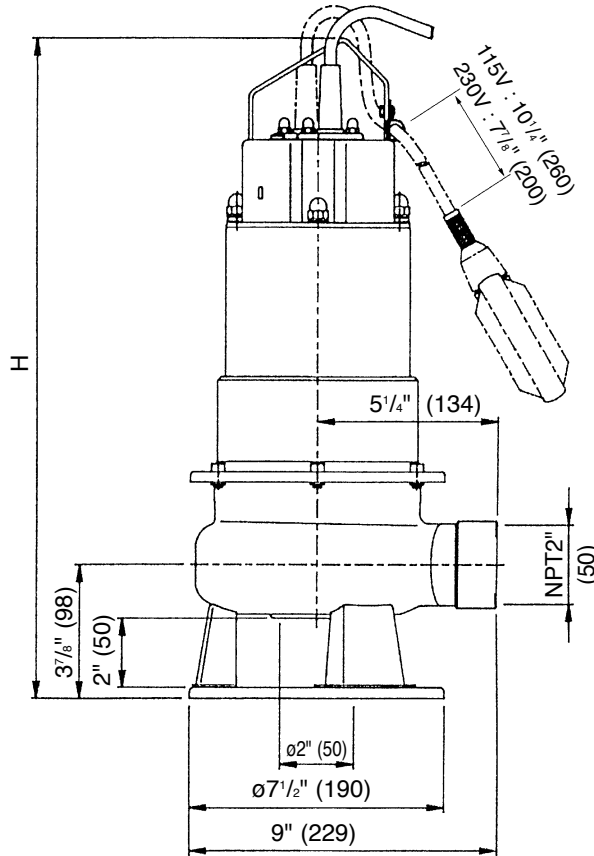

**Model DWAU**

Phase	Size ø	Model	Output		Pump	Weight Lbs (kg)
			kw	HP	H	
Single	2" (50mm)	50DWAU6.4S	0.4	1/2	21 <sup>5</sup> / <sub>8</sub> (550)	35 (16)
		50DWAU6.75S	0.75	1	22 <sup>13</sup> / <sub>16</sub> (580)	40 (18)
		50DWAU6.4S2	0.4	1/2	19 <sup>1</sup> / <sub>8</sub> (485)	35 (16)
		50DWAU6.75S2	0.75	1	20 <sup>1</sup> / <sub>4</sub> (515)	40 (18)
		50DWAU61.1S2	1.1	1 1/2	20 <sup>1</sup> / <sub>4</sub> (515)	44 (20)

**Model DWXAU**

Phase	Size ø	Model	Output		Pump	Weight Lbs (kg)
			kw	HP	H	
Single	2" (50mm)	50DWXAU6.4S	0.4	1/2	21 <sup>5</sup> / <sub>8</sub> (550)	35 (16)
		50DWXAU6.75S	0.75	1	22 <sup>13</sup> / <sub>16</sub> (580)	40 (18)
		50DWXAU6.4S2	0.4	1/2	19 <sup>1</sup> / <sub>8</sub> (485)	35 (16)
		50DWXAU6.75S2	0.75	1	20 <sup>1</sup> / <sub>4</sub> (515)	40 (18)
		50DWXAU61.1S2	1.1	1 1/2	20 <sup>1</sup> / <sub>4</sub> (515)	44 (20)